

*Mayur*  
2 & 3 BHK APARTMENTS

@ SIDDHA AANGAN  
BEFORE TOLL, AJMER ROAD, JAIPUR

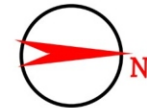

RERA Registration No. :  
**RAJ/P/2017/087**



1. Central Landscape Green
2. Swimming Pool
3. Pool Front Plaza
4. Badminton Court
5. Orchard Garden
6. Party Lawn
7. Round About
8. Garden Area
9. Kids' Play Area
10. Water Feature
11. Shade Stilt Garden
12. Senior Citizen Garden
13. Club House

**SIDDHA AANGAN**

- Phase-i (block 1 & 2)
- Phase-ii (villas)
- Phase-iii (block 3 & 4)
- Phase-iv (block 5,6 & Club)

## TYPICAL FLOOR PLAN

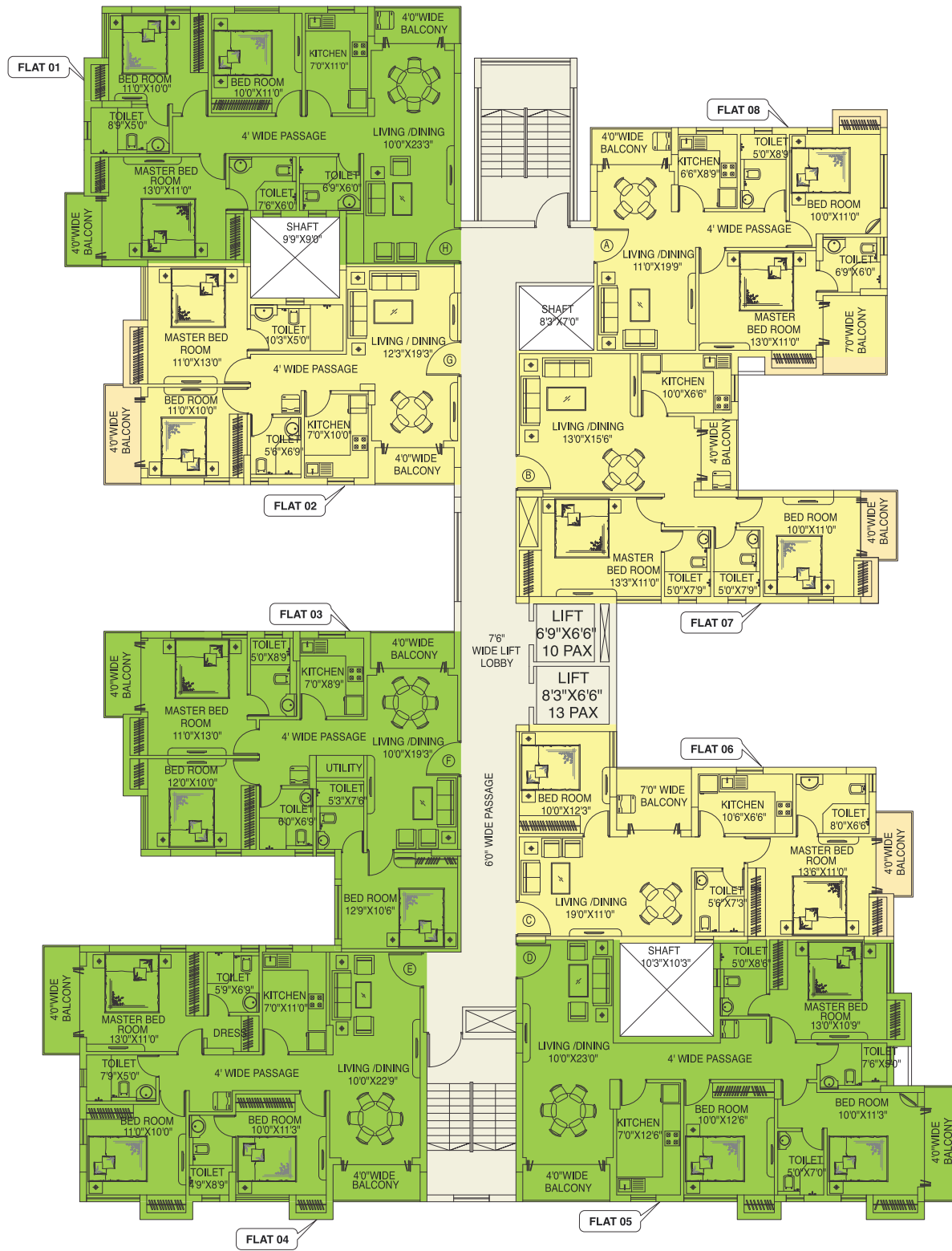

Flat No.	1	2	3	4	5	6	7	8
Type	3 BHK	2 BHK	3 BHK	3 BHK	3 BHK	2 BHK	2 BHK	2 BHK
SBU Area (sq. ft.)	1472	1141	1400	1477	1587	1114	1139	1095
Carpet Area (sq. ft.)	956.62	722.06	907.16	954.61	1008.07	677.92	725.08	676.82
Carpet Area of Exclusive Balcony (sq. ft.)	67.35	72.18	69.41	75.83	82.89	92.02	55.46	82.26

● 2 BHK ● 3 BHK





## TESTIMONIALS



We found the home we wanted in Baya "Siddha Aangan". On May 16th, we called Siddha, looked at the township which was exactly what we wanted. We bought the home very next day. Thank you, Siddha for all you did in making our first home purchase a delightful event!

**- Pratiksha Payal & Mrinal Singh**



Since a long time we were looking for the Villa of our dreams to call our home and the search ended at Siddha Aangan. The project location and layout of Villas is excellent. The sales people namely Ritesh & Maneesh are very nice and understood each of our needs. We are completely satisfied with our decision.

**- Mrs. Neetu Rajesh Agarwal**



I am pleased with all the support and the information provided by Siddha team members that helped us to make this decision. We hope to get the same support in all future correspondence also.

**- Mrs. Poonam Onkar Chawla**



It was an absolute joy buying my property from Siddha. I have dealt with a few other developers earlier, and this was by far my best experience so far. Excellent co-ordination, fast response, well informed team members and unbiased advice - they have it all. Here's wishing them all the best!

**- Saroj Praveen Mandawaria**

## LIFE @ SIDDHA AANGAN



## TOWNSHIP HIGHLIGHTS



24 X7 MANNED SECURITY



AMPLE WATER SUPPLY



ELECTRICITY BACK-UP IN COMMON AREAS



SHUTTLE SERVICE



CLUBHOUSE FACILITIES



CONVENIENCE STORE



LANDSCAPED GREENS

## CONSTRUCTION SPECIFICATIONS

### SUPER - STRUCTURE

Earthquake resistance RCC framed structure with monolithic concrete

### DOORS

Solid timber frames  
Solid core flush shutters

### WINDOWS

Anodized powder coated-aluminium frames with fully glazed shutters

### FLOORING

Glazed vitrified/ceramic tiles in all bedrooms, living/dining rooms & balcony

### KITCHEN

Floor: Anti-skid ceramic tiles  
Countertops: Granite with steel sink  
Dados: Ceramic tiling upto 2 feet from the granite counter tops

### TOILET

Floor: Anti-skid ceramic tiles  
Dados: Ceramic tiles upto 7 feet/upto soffit of lintel level

### SANITARY WARE

Chromium plated fittings, white high quality porcelain fixtures.

### ELECTRICALS

Superior quality concealed copper (fire resistance low smoke) wiring  
Latest modular switches and miniature circuit breakers, TV socket, broadband point

### TELEPHONE WIRING

Central distribution console networked with all apartments

### EXTERIOR

Latest weather proof exterior finish

### LIFT FACIA

Granite

### LIFT LOBBY

Vitrified/Ceramic Tiles



**RERA Registration No. :  
RAJ/P/2017/087**



**9309 450 450**

328-329, 2nd Floor, Nemi Sagar, Queens Road, Vaishali Nagar, Jaipur - 302 021  
T 0141 2352577 | E jaipur@siddhagroup.com | W siddhaangan.com

Download the "Siddha Group" App:



Follow us: [f](#) [t](#) [in](#)

Disclaimer: All Information, features and offerings in this handout are subject to change without notice. Photographs used in the handout are for illustration purpose only and may not bear any resemblance to actual features/ offerings. This handout is not a legal offering or document.